

AGLCS Series: GRP Local Control Station & Switches

Increased Safety

Zones 1 & 2 – 21 & 22
Gas (G) and Dust (D)
IP66

Highlights

Application

- Providing local and motor control for hazardous areas in explosive gas Zone 1 and 2 or explosive dust Zone 21 and 22 environments.
- Applicable in wash down areas for indoor or outdoor application where water and dust ingress protection is required.
- Suitable for highly corrosive environment that has either chemical, moist or salt-water (marine outside type) in the surrounding area.
- Push buttons and selector switches provides circuit control and/or selection which are used in conjunction with contactors or magnetic starters for remote control of motors in hazardous locations.
- Pilot lights gives visual assurance that an electrical function is being performed at a remote or hazardous location.
- For use in different field application such as
 - Oil and Gas
 - Petrochemical
 - Pulp and Paper
 - Food & Beverage Processing
 - Water and Wastewater Treatment
 - Power Generation
 - Pharmaceutical Industry
 - Silos and Other Industrial Process Facilities.

Features

- Static resistant black glass reinforced polyester enclosure.
- The high IP rating allows the enclosure to be installed in either indoor or outdoor environments.
- Designed for application with voltage ratings up to 5,500V AC and rated current up to 1,500A.
- Multiple enclosure size for different control, indicator or selector configurations.
- Utilizes factory sealed (Ex e or de) operators which includes push buttons, illuminated push buttons, ammeter, selector switches, control and load break switches, contact blocks, LED pilot lights, and terminal blocks.
- Using high intensity LED pilot lights which has a lifetime of 100,000 hours, it can be used for inputs with 12V AC to 254V AC 50/60Hz or 12V DC to 60V DC
- Operators and contact blocks are properly spaced to have easy and ample space for wiring.
- Up to 3 contact blocks per actuator can be used.

■ Contact block technical data:

- IEC rated operating voltage (Ue): 500V AC – 110V DC
- IEC switching capacity:

AC12: 16 Amp/400V AC	DC13: 2 Amp/24V DC and 1 Amp/110V DC
AC14: 10 Amp/400V AC	
AC15: 6 Amp/500V AC	

- NEMA switching capacity: A600: 10 Amp/600V AC



■ Selector switch technical data:

- IEC rated operating voltage: 690V AC
- IEC rated operating current: maximum 16 Amp
- IEC switching capacity:

AC1: 16 Amp/690V AC	DC1: 10 Amp/24V DC
AC15: 16 Amp/415V AC	DC1: 6 Amp/60V DC
AC3: 8 Amp/500V AC	DC1: 6 Amp/110V DC
AC3: 4 Amp/690V AC	(2 contacts wired in series)
AC3: 16 Amp/690V AC	DC1: 6 Amp/220V DC
	(3 contacts in series)

- NEMA switching capacity: A600: 10 Amp/600V AC

- Components are DIN rail mounted which is held securely in place during operation and easily removed for service.
- Captive, corrosion resistant stainless steel cover screws.
- Multiple wiring or cable termination with a wide selection of cable glands and union adapters for the entries at 4 sides of the enclosure.

Materials

- Enclosures: Glass reinforced plastic
- Gasket: Silicone
- Cover Screws: Stainless steel
- Nameplates: Stainless steel or Laminated plastic (with different color as special request).

Options

- Mounting plate is supplied in zinc plated steel as standard. Stainless steel can be requested as special.
- Nameplates, Earth continuity brass plate, Blanking plugs, and Cable glands are offered as separate items.
- Consult factory for custom drilling, assembly requirements and other accessories.

AGLCS Series: GRP Local Control Station & Switches

Increased Safety

Zones 1 & 2 – 21 & 22
Gas (G) and Dust (D)
IP66

Certificate & Compliances

- Gas (Zone 1 and 2)
 - Conforming to directive 2014/34/EU: Ex II 2G
 - Type of protection:
 - Ex eb IIC T5/T6 Gb,
 - Ex ia IIC T5/T6 Gb,
 - Ex eb ia IIC T5/T6 Gb
 - Temperature class: T6 to T5
- Dust (Zone 21 and Zone 22)
 - Conforming to directive 2014/34/EU: Ex II 2D
 - Type of protection:
 - Ex tb IIIC T80°C/T95°C Db IP66;
 - Surface temperature: T80°C to T95°C
- Ambient temperature: -35°C up to + 40°C/-35°C up to +55°C
- ATEX certificate: CE 2460 ExVeritas 18 ATEX 0330X
 CE 2460 ExVeritas 18 ATEX 0327U
 CE 2585 ExVeritas 18 ATEX 0330X
 CE 2585 ExVeritas 18 ATEX 0327U
- IECEX certificate: IECEX EXV 18.0006X
IECEX EXV 18.0004X
- Ingress protection: IP66 (According to EN/IEC 60529)

Catalog Numbering Guide

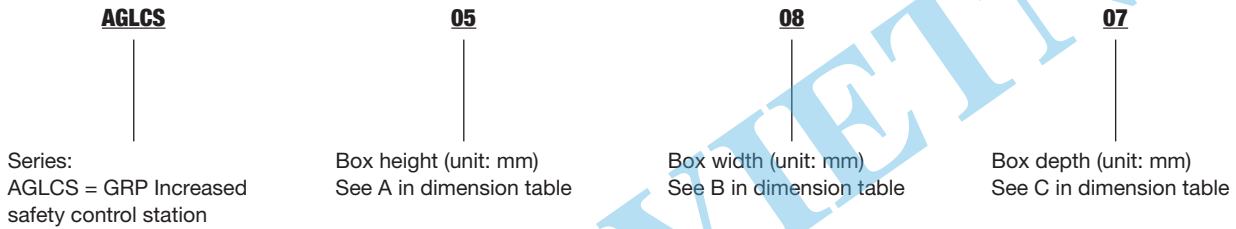

Dimensions

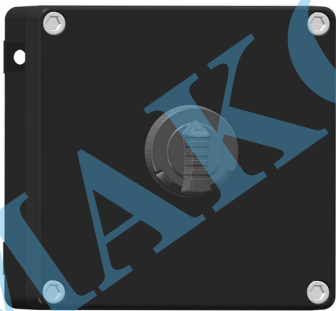

Type 1

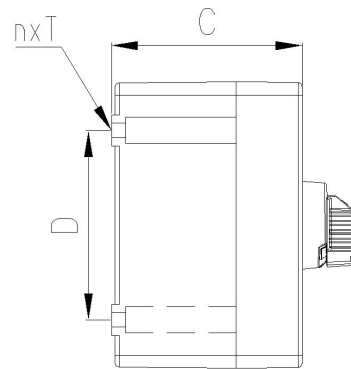
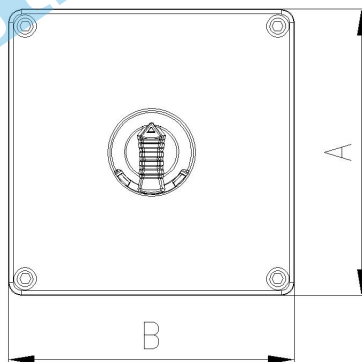

Catalogue Number	Dimension (mm)						
	A	B	C	D	E	n	T
AGLCS111410	110	139	100	96	91	2	Ø6
AGLCS131308	130	130	86	86	116	2	Ø6
AGLCS132212	130	220	120	116	172	2	Ø6
AGLCS141110	139	110	100	91	96	2	Ø6
AGLCS221312	220	130	120	172	116	2	Ø6

AGLCS Series: GRP Local Control Station & Switches

Increased Safety

Zones 1 & 2 – 21 & 22
Gas (G) and Dust (D)
IP66



Type 2

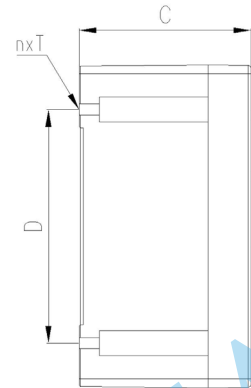
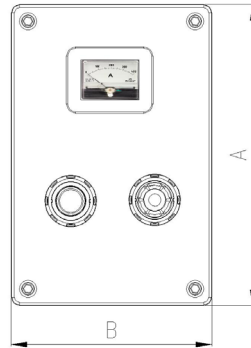

Catalogue Number	Dimension (mm)						
	A	B	C	D	E	n	T
AGLCS122209	122	220	90	82	204	4	Ø6
AGLCS162609	160	260	90	110	239	4	Ø6
AGLCS163609	160	360	90	112	340	4	Ø6
AGLCS182612	180	260	120	163	200	4	Ø7
AGLCS221209	220	122	90	204	82	4	Ø6
AGLCS223612	220	360	120	200	296	4	Ø9
AGLCS223617	220	360	170	200	296	4	Ø9
AGLCS261609	260	160	90	239	110	4	Ø6
AGLCS261812	260	180	120	200	163	4	Ø7
AGLCS334516	330	450	160	304	379	4	Ø9
AGLCS334524	330	450	240	304	379	4	Ø9
AGLCS361609	360	160	90	340	112	4	Ø6
AGLCS362212	360	220	120	296	200	4	Ø9
AGLCS362217	360	220	170	296	200	4	Ø9
AGLCS363612	360	360	120	297	340	4	Ø9
AGLCS363617	360	360	170	297	340	4	Ø9
AGLCS405222	400	520	220	383	457	4	Ø10
AGLCS453316	450	330	160	379	304	4	Ø9
AGLCS453324	450	330	240	379	304	4	Ø9
AGLCS524022	520	400	220	457	383	4	Ø10

AGLCS Series: GRP Local Control Station & Switches

Increased Safety

Zones 1 & 2 – 21 & 22
Gas (G) and Dust (D)
IP66

APPLETON™

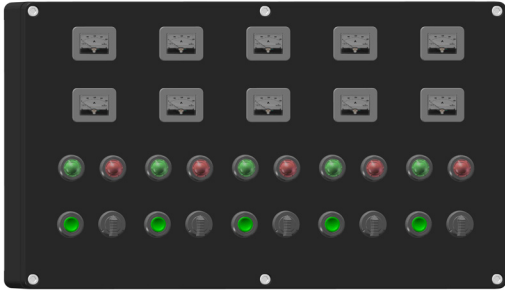

Type 3

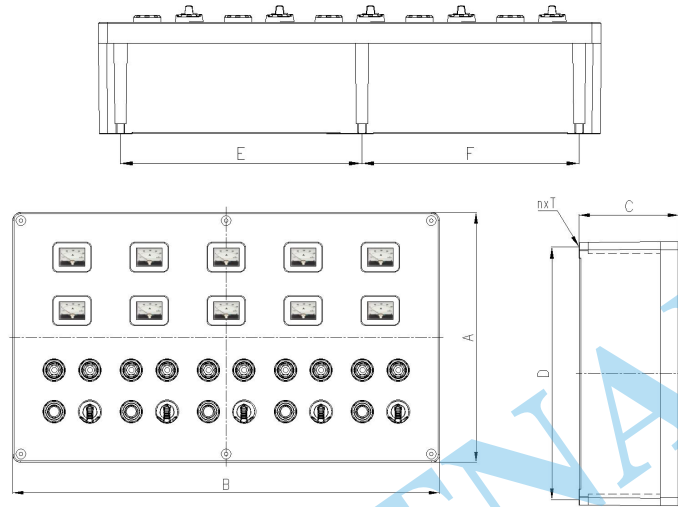

Catalogue Number	Dimension (mm)							
	A	B	C	D	E	F	n	T
AGLCS427216	420	720	160	401	311	346	6	Ø10
AGLCS427224	420	720	240	401	311	346	6	Ø10
AGLCS724216	720	420	160	401	311	346	6	Ø10
AGLCS724224	720	420	240	401	311	346	6	Ø10

Design Configuration

Drawing legend:

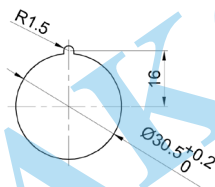

Clearance hole for operators and illuminated controls (i.e. Push button, Push-pull emergency stop, Mushroom-head push button, Key push button, Pilot light and selector switches).

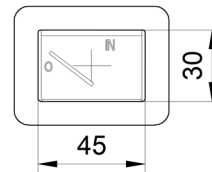

Clearance opening for ammeter

Max configuration	Maximum qty of holes		Catalog number	H x W x D Dimension in millimetres
	Push button	Ammeter		
	2	-	AGLCS111410 AGLCS141110	110 x 139 x 100 139 x 110 x 100
	-	1		

Note:

- The maximum configuration drawing is for visual illustration only, actual product may vary depending on the customized configuration of operator and controls.
- Please consult with our sales office for local control station with different configurations.

AGLCS Series: GRP Local Control Station & Switches

Increased Safety

Zones 1 & 2 – 21 & 22
Gas (G) and Dust (D)
IP66

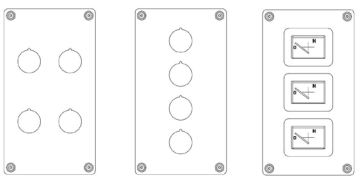
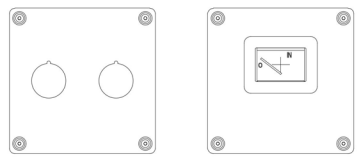
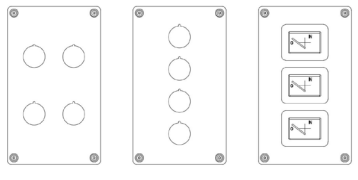
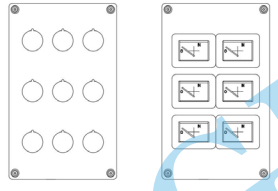
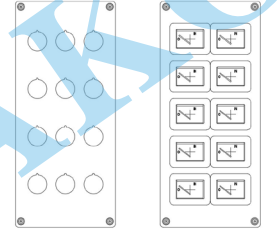
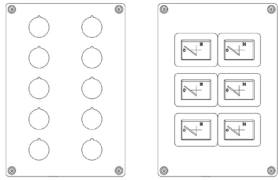
Max configuration	Maximum qty of holes		Catalog number	H x W x D Dimension in millimetres
	Push button	Ammeter		
	4	–	AGLCS122209 AGLCS221209	122 x 220 x 90 220 x 122 x 90
	–	3		
	2	–	AGLCS131308	130 x 130 x 86
	–	1		
	4	–	AGLCS132212 AGLCS221312	130 x 220 x 120 220 x 130 x 120
	–	3		
	9	–	AGLCS162609 AGLCS261609	160 x 260 x 90 260 x 160 x 90
	–	6		
	12	–	AGLCS163609 AGLCS361609	160 x 360 x 90 360 x 160 x 90
	–	10		
	10	–	AGLCS182612 AGLCS261812	180 x 260 x 120 260 x 180 x 120
	–	6		

Note:

- The maximum configuration drawing is for visual illustration only, actual product may vary depending on the customized configuration of operator and controls.
- Please consult with our sales office for local control station with different configurations.

AGLCS Series: GRP Local Control Station & Switches

Increased Safety

Zones 1 & 2 – 21 & 22
Gas (G) and Dust (D)
IP66

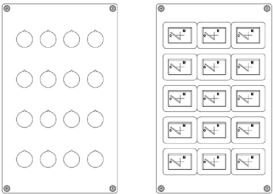
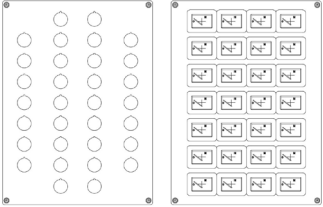
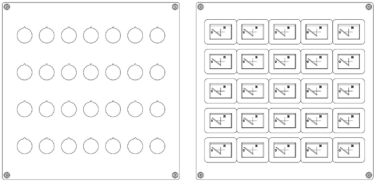
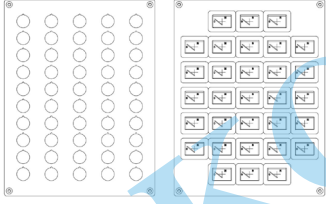
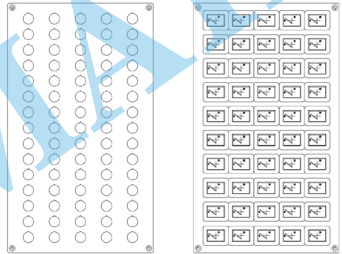
Max configuration	Maximum qty of holes		Catalog number	H x W x D Dimension in millimetres
	Push button	Ammeter		
	16	–	AGLCS223612 AGLCS362212 AGLCS223617 AGLCS362217	220 x 360 x 120 360 x 220 x 120 220 x 360 x 170 360 x 220 x 170
	–	15		
	32	–	AGLCS334516 AGLCS453316 AGLCS334524 AGLCS453324	330 x 450 x 160 450 x 330 x 160 330 x 450 x 240 450 x 330 x 240
	–	28		
	28	–	AGLCS363612 AGLCS363617	360 x 360 x 120 360 x 360 x 170
	–	25		
	50	–	AGLCS405222 AGLCS524022	400 x 520 x 220 520 x 400 x 220
	–	31		
	75	–	AGLCS427216 AGLCS724216 AGLCS427224 AGLCS724224	420 x 720 x 160 720 x 420 x 160 420 x 720 x 240 720 x 420 x 240
	–	50		

Note:

- The maximum configuration drawing is for visual illustration only, actual product may vary depending on the customized configuration of operator and controls.
- Please consult with our sales office for local control station with different configurations.